

High-Speed Positioning System

www.boschsecurity.com



BOSCH

Invented for life



- ▶ Pans up to 100° per second, 360° continuous rotation
- ▶ Tilts up to 40° per second, -90° to +40° range
- ▶ Choice of Dinion^{XF} Color or Dinion 2X Day/Night cameras and motorized zoom lens combinations
- ▶ IP 66 rated, tough, attractive casing with up to 20 kg balanced load
- ▶ Optional Bosch AEGIS UFLED Infrared Illuminator assembly attaches directly to the High-Speed Positioning System for operation in dark environments

The Bosch High-Speed Positioning System (HSPS) is a complete solution that is high on quality and performance. It can pan 360° continuously at speeds of up to 100° per second. An extensive range of options lets you tailor the system to your specific requirements. For example, the HSPS offers a variety of Dinion^{XF} and Dinion 2X cameras and lens combinations, and the system can be ordered with two Bosch AEGIS UFLED Infrared Illuminators for operation in dark environments.

Autopan and patrol functions are accurate to within 0.02°, with text labels assigned to presets for added convenience. Automatic lens scaling, which keeps zoom and speed synchronized, ensures smooth video pictures throughout pan and tilt movement. A completely self-contained unit, the High-Speed Positioning System is easy to install and maintain. Multi-protocol capabilities, including Bilinx and Biphase, also simplify connections. The tough, protective casing can support a 20 kg balanced load and is IP66-rated – ideal for weathering the outdoor conditions common in traffic and industrial applications. All units have a sunshield and an integrated wiper. The wiper is available with an optional washer.

High-Speed Pan/Tilt with Infrared Illumination

The IR 360 version of the High-Speed Positioning System comes with a bracket and two Bosch AEGIS UFLED Infrared Illuminators, without the need for rotating cables. The IR 360 system features two local alarm inputs, one input for synchronizing the infrared lighting and one relay output for an intelligent local alarm.

System overview

Modular Design

The High-Speed Positioning System is based on four modules: the camera and lens sled assembly, the Main Pan/Tilt unit including the base power supply, the optional mounting hardware and the optional illuminators.

The modular design allows you to customize an HSPS to fit your specific application. To build an HSPS, select one option from **Modules A and B**. In addition, you may further customize your HSPS by selecting an optional mounting solution from **Module C** and two optional illuminators from **Module D**.

Module A: Camera and Lens Combination

Choose from a selection of Bosch Dinion cameras and lenses. This module comes pre-assembled and attached to a sled that is installed inside the HSPS housing. Use this ordering chart to construct the Camera/Lens combination:

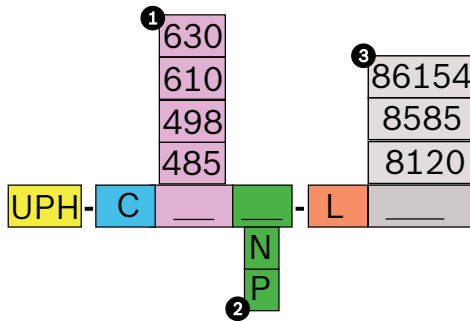
**1 Camera**

485	LTC 0485 Dinion ^{XF} Color Camera, 1/3 in.
498	LTC 0498 Dinion 2X Day/Night Camera, 1/3 in.
610	LTC 0610 Dinion ^{XF} Color Camera, 1/2 in.
630	LTC 0630 Dinion 2X Day/Night Camera, 1/2 in.

2 Video Format

N	NTSC
P	PAL

3 Lens

8120	8-120 mm motorized zoom lens
8585	8.5-85 mm IR-corrected motorized zoom lens
86154	8.6-154 mm IR-corrected motorized zoom lens

Module B: Pan/Tilt System with Power Supply

Choose a main pan/tilt system and power supply combination. The **Standard System** contains a high-performance pan/tilt head, camera housing with an optional integrated wiper, and a telemetry receiver. The **IR 360 System** contains all the Standard System features plus a bracket assembly for two (2) illuminators.

Option	Description
UPH-HD-230	<ul style="list-style-type: none"> Standard System 230 VAC, 50 HZ Power Supply
UPH-HWD-230	<ul style="list-style-type: none"> Standard System Wiper 230 VAC, 50 HZ Power Supply
UPH-HWD-120	<ul style="list-style-type: none"> Standard System Wiper 120 VAC, 60 HZ Power Supply
UPH-HD-24	<ul style="list-style-type: none"> Standard System

	<ul style="list-style-type: none"> 24 VAC, 50/60 HZ Power Supply
UPH-HWD-24	<ul style="list-style-type: none"> Standard System Wiper 24 VAC, 50/60 HZ Power Supply
UPH-HWDIR-24	<ul style="list-style-type: none"> IR 360 System Wiper 24 VAC, 50/60 Hz Power Supply

Module C: Mounts

Choose an optional mounting solution for the Standard or for the IR 360 System.

Option	Description
MTC-PUPH	Top of pole mount
MTC-WUPH	Wall mount
MTC-CORN-W	Corner adapter for wall mount
MTC-POLE-W	Side of pole adapter for wall mount

Module D: Illuminators

Choose two (2) optional Bosch AEGIS UFLED Intelligent Infrared Illuminators.^{1, 2, 3}

Suggested Models	Description
UFLED10-8BD	10°, 850 nm
UFLED20-8BD	20°, 850 nm
UFLED30-8BD	30°, 850 nm

1. The IR Illuminator option is available only with the UPH-HWDIR-24 (IR 360 Main Pan/Tilt System).

2. You may select two of the same or two different illuminators.

3. 940 nm (covert) and White Light (visible) wavelength options also compatible.

Performance characteristics will vary. See the UFLED datasheet for illumination distances.

Functions**Multi-protocol**

The High-Speed Positioning System operates with Bosch hardware platforms – Divar, DiBos, Allegiant – and is fully compatible with control protocols such as Biphas, Bilinx, Pelco-D, and third party protocols on RS-485. Biphas allows control of pan, tilt, zoom, focus, and the wiper / washer. Bilinx offers the same functionality as Biphas, with additional communication capability for configuring Dinion camera settings.

High-Speed Pan/Tilt with Automatic Scaling

The unit can reach a very fast panning speed of 100° per second with 360° continuous panning in manual mode. The HSPS can achieve tilt speeds of 40° per second in manual mode. It also offers ample scope for changing the horizontal view, with movement ranging between -90° below and +40° above the horizon. To ensure smooth, clear pictures during rapid movement, automatic scaling synchronizes the pan/tilt speed to the amount of zoom.

Dinion^{XF}- and Dinion 2X-Dynamic Cameras

The Bosch-High Speed Positioning System comes with a choice of 1/3-inch or 1/2-inch Dinion^{XF} Color or Dinion 2X Day/Night CCDs with 540 TVL resolution, and outstanding sensitivity. The Dinion cameras deliver the highest possible image quality even in the most difficult lighting conditions.

Using 2X-Dynamic technology, pixel-by-pixel analysis provides the user with the most detailed information. Turn on SmartBLC to automatically compensate the image without the need for complicated set-up or compromising dynamic range.

XF-Dynamic

The highly accurate 15-bit (Dinion^{XF} cameras) or 20-bit (Dinion 2X) digital signal is automatically processed to optimally capture the detail in both the high and low light areas of the scene simultaneously, maximizing the information visible in the picture.

NightSense and SensUp

Dinion^{XF} Color cameras feature NightSense which increases sensitivity by 9 dB in monochrome mode. NightSense can be automatically activated in low light situations, or remotely using Bilinx.

Dinion^{XF} and Dinion 2X Day/Night cameras make optimal use of the available lighting by utilizing the built-in SensUp feature. By increasing the integration time on the CCD up to 10 times, the effective sensitivity is dramatically enhanced. This is especially useful when relying only on moonlight for illumination.

Default Shutter

When viewing moving objects a fast shutter speed is required. When using a fast shutter speed the lens opening or gain control needs to be increased to maintain the video signal. The camera sensitivity is limited by the fast shutter speed. The default shutter setting offers the best of all worlds, fast shutter speed as long as there is sufficient light, however as the light level falls, when other adjustments have been exhausted, the shutter reverts to the standard setting maintaining the cameras excellent sensitivity.

Auto Black

The automatic black level feature enhances contrast by compensating for reduced contrast (i.e. glare, fog, mist).

Programmable Modes

Dinion cameras support three independent operating modes. The three modes are preprogrammed for typical applications, but are fully programmable for individual situations. Switching between modes is easy via Bilinx or the external alarm input

Infrared Illumination

The Bosch AEGIS UFLED, the world's first Intelligent-infrared illuminator, combines innovations in infrared technology and design to deliver absolute performance in night vision surveillance.

Constant Light technology compensates for LED degradation, a natural occurrence with all LED-based illuminators, to deliver a constant level of lighting performance throughout the life of the illuminator. Powered by award-winning 3D-Diffuser technology, Bosch AEGIS UFLED delivers Even-Illumination which lights the foreground and background of the scene eliminating hotspots and underexposure.

Certifications and approvals

Safety	acc. to EN 60950 (CE), UL
Immunity	acc. to EN 50130-4 (CE)
	acc. to EN 55022 Class B (CE)
Emission	acc. to EN 61000-3-2 (CE)
	acc. to EN 61000-3-3 (CE)
Water/dust protection	IP 66 acc. to EN 60529

Installation/configuration notes

For more information on Dinion cameras (e.g. LTC 0498) and motorized zoom lenses (e.g. LTC 3783/51), please refer to their specific product datasheets.

HSPS Standard System Dimensions

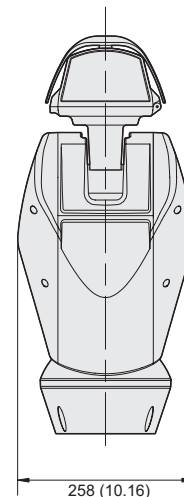

HSPS IR 360 System Dimensions

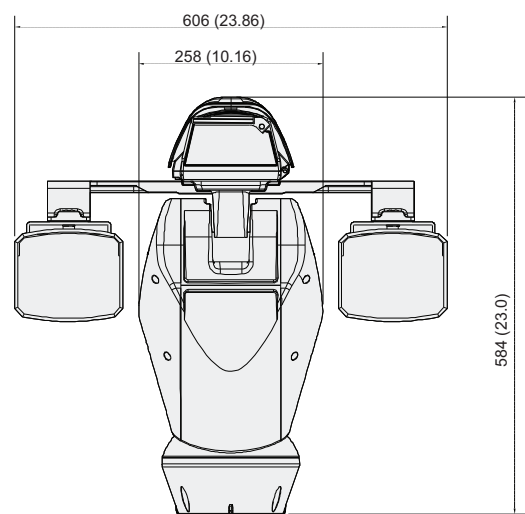
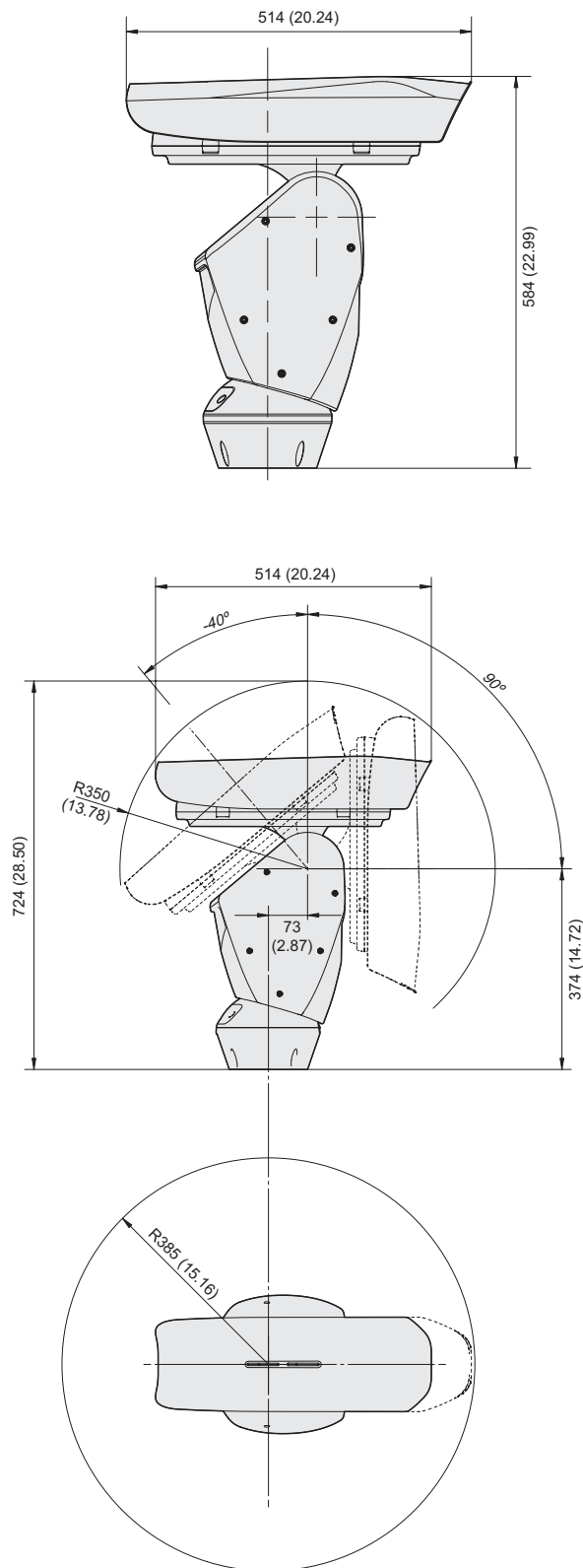

MTC-WUPH

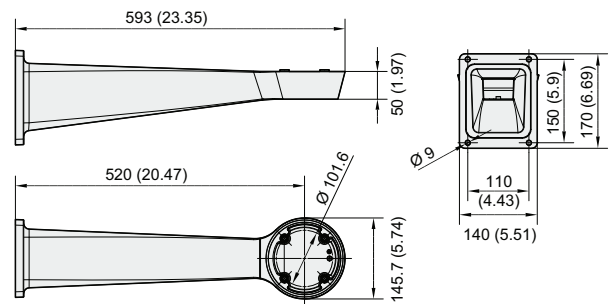

MTC-PUPH (top of pole)

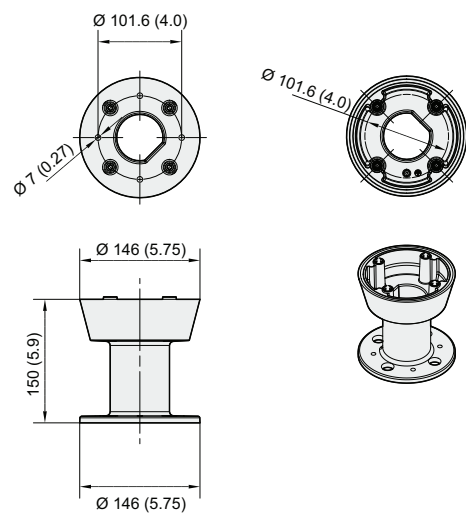

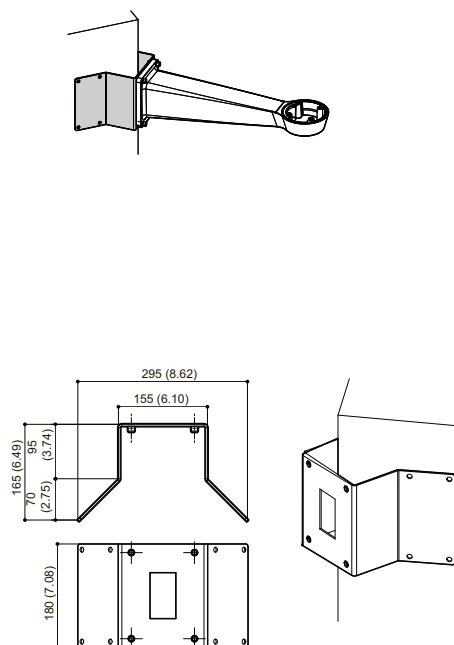
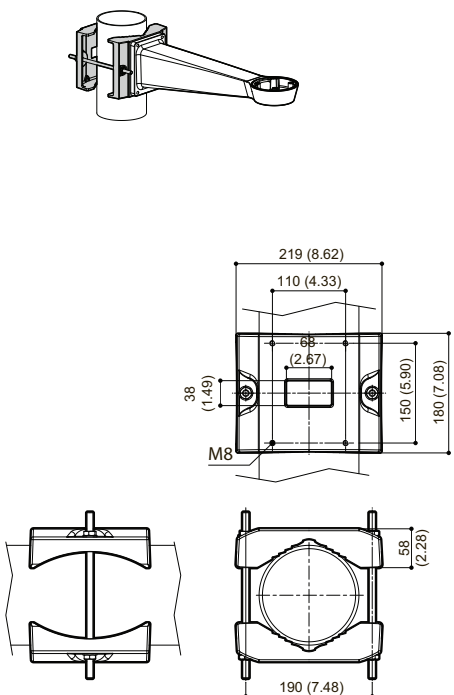
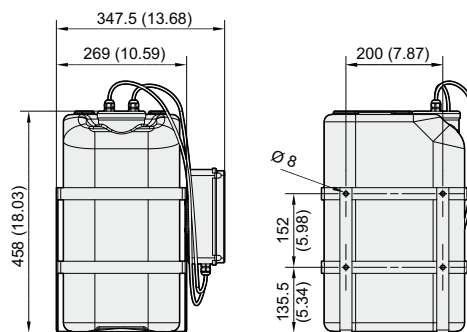
MTC-CORN-W**MTC-POLE-W (side of pole)****HAC-WAS05**

Dimensions—mm (in.)

Parts included

Quantity	Component
1	Main Pan/Tilt System
1	Base unit with power supply
1	Pre-assembled Bosch Dinion ^{XF} Color or Dinion 2X Day/Night camera and motorized zoom lens assembly
1	Mounting kit (optional)
1	Illuminator bracket assembly (optional)
2	Bosch AEGIS UFLED Infrared Illuminators (optional)
1	Serial cable
1	Serial adapter
1	Installation manual
1	Set of mounting accessories <ul style="list-style-type: none"> • 4 mm Allen wrench • Bracket with fixing screws • Cable ties • Tube • Label

Technical specifications**High-Speed Positioning System****Electrical**

Input Voltage	
• Standard System	24 VAC
• IR 360 System	24 VAC
Power Draw (max.)	
• Standard System	5 A
• IR 360 System	8 A
Input Frequency	50/60 Hz

Integrated Housing Input	Thermostat heater, 24 VAC, 20 W max.
Camera Input	12 VDC, 800 mA
Lens Input	+6 to +15 VDC, 200 mA
Wiper (optional) Input	24 VAC, 400 mA
Illuminator (optional) Input	24 VAC, 2 A + 2 A max.
Tour Control	Autopan; Preset; Patrol
Presets	250 selectable (max. 99 via keyboard)
Preset / Area Names	20-character string
Preset Accuracy	0.02°
Data Set-up	Flash memory
Serial	RS-232, Sub-D for firmware upgrade
Protocols	Bilinx, Biphase, Pelco-D, and third party protocols on RS-485
Supported Platforms	DiBos, Divar, Allegiant
Max. Addressable Units	Bilinx/Biphase: 998 (dipswitch setting) Pelco-D: 255 (dipswitch setting)
Firmware Upgrades	RS-232 interface
Configuration Modes	Via PC or OSD
Configuration Interface	RS-485

Mechanical

Dimensions (H x W x D)	584 x 258 x 514 mm (23.0 x 10.2 x 20.2 in.)	
Weight	Approx. 14 kg (31 lb)	
Mounting	Top mount (OTT)	
Color	Light grey (RAL 7035)	
Material	Die cast and extruded aluminum, ABS	
Rotation		
Horizontal	360° continuous	
Vertical	-90° to +40°	
Speed	Manual	Patrol / Autopan
Horizontal (pan)		
• Standard System	0.1° to 100°/s	0.1° to 100°/s
• IR 360 System	0.1° to 40°/s	0.1° to 40°/s
Vertical (tilt)		
• Standard System	0.1° to 40°/s	0.1° to 30°/s
• IR 360 System	0.1° to 30°/s	0.1° to 30°/s
Static / Dynamic Torque		
Horizontal	20 Nm	

Vertical	20 Nm
Transmission	Toothed belt

Environmental

Operating Temperature	-20 °C to +50 °C (-4 °F to +122 °F)
Storage Temperature	-20 °C to +60 °C (-4 °F to +140 °F)
Humidity	<90% relative humidity (non-condensing)
Enclosure Protection	IP 66

Camera Specifications

UPH-C485 Series

Camera Model	LTC 0485 Dinion ^{XF} Color, 1/3-inch Digital CCD Camera
Active Pixels	
NTSC	768 H x 492 V
PAL	752 H x 582 V

Sensitivity (3200 k)

Sensitivity (full video) ⁴	2.4 lux (0.24 fc)
Sensitivity 50 IRE ⁴	0.59 lux / 0.24 lux (NightSense) (0.059 fc / 0.024 fc (NightSense))
Minimum Illumination ⁴	0.24 lux / 0.10 lux (NightSense) (0.024 fc / 0.01 fc (NightSense))
Minimum Illumination with SensUp	0.024 lux / 0.010 lux (NightSense) (0.0024 fc / 0.0010 fc (NightSense))
Horizontal Resolution	540 TVL
Signal-to-Noise-Ratio	> 50 dB
Video Output	1 Vpp, 75 Ohm
Y/C Output	Y: 1 Vpp / C: 0.3 Vpp
Synchronization	Internal, Line Lock, HV-lock and genlock (Burst lock) selectable
Electronic Shutter	Auto (1/60 [1/50] to 1/500000), fixed, flickerless, default
SensUp	Off, automatic continuous up to 10x
Auto Black	On, off selectable
Range	32x dynamic range enhancement
Dynamic Noise Reduction	Auto, off selectable
Contour	Sharpness enhancement level selectable
BLC	Off, area and level selectable

Gain	Auto (maximum level selectable to 28 dB) or fixed level selectable
White Balance	ATW (2500–10000 K), AWB hold, manual WB selectable
VMD	Four (4) area, sensitivity selectable
Alarm Output	VMD or Bilinx
Alarm Input (TTL)	Profile switching, +5 V nominal, +40 VDC max.
Alarm Output Relay	Max. 30 VAC or +40 VDC, max. 0.5 A continuous, 10 VA
External Synchronal Input	75 Ohm or High Impedance selectable
Cable Compensation	Up to 1000 m (3000 ft) coax without external amplifiers (automatic set-up in combination with coaxial communication)
Camera ID	16-character editable string, position selectable
Remote Control	Bi-directional coaxial communication

4. F1.2, 89% reflection, SensUp Off

UPH-C498 Series

Camera Model	LTC 0498 Dinion 2X Day/Night, 1/3-inch Digital CCD Camera
Active Pixels	
NTSC	768 H x 494 V
PAL	752 H x 582 V

Sensitivity (3200 K, scene reflectivity 89%, F1.2)

	Full video (100 IRE)	Usable picture (50 IRE)	Usable picture (30 IRE)
Color	2.4 lx (0.24 fc)	0.59 lx (0.059 fc)	0.24 lx (0.024 fc)
Color + SensUp 10x	0.24 lx (0.024 fc)	0.059 lx (0.0059 fc)	0.024 lx (0.0024 fc)
Monochrome	-	0.08 lx (0.008 fc)	0.038 lx (0.0038 fc)
Monochrome + SensUp 10x	-	0.008 lx (0.0008 fc)	0.0038 lx (0.00038 fc)

Horizontal Resolution	540 TVL
Signal-to-Noise Ratio	>50 dB
Video Output	Composite video 1 Vpp, 75 ohm
Synchronization	Internal, Line Lock, HV-lock and Genlock (Burst lock) selectable
Shutter	Auto (1/50 [1/60] to 1/10000) selectable Auto (1/50 [1/60] to 1/50000) automatic flickerless, fixed selectable
SensUp	Adjustable from Off up to 10x

Day/Night	Color, Mono, Auto
Auto Black	Automatic continuous, Off
Dynamic Engine	XF-Dynamic, 2X-Dynamic, SmartBLC
Dynamic Range	120 dB (20-bit image processing)
Dynamic Noise Reduction	Auto, On/off selectable
Sharpness	Sharpness enhancement level selectable
SmartBLC	On/Off
AGC	AGC On/Off (0 dB) selectable
Peak White Invert	On/Off
White Balance	ATW, ATWhold and manual (2500–10000 K)
Alarm Output	VMD or Bilinx
Alarm Input (TTL)	Profile switching, +3.3 V nominal, +40 VDC max.
Alarm Output Relay	30 VAC or +40 VDC, max. 0.5 A continuous, 10 VA
External Synchronization Input	75 Ohm or High Impedance selectable
Cable Compensation	Up to 1000 m (3000 ft) coax without external amplifiers (automatic set-up in combination with Bilinx coaxial communication)
Camera ID	17-character editable string, position selectable
Test Pattern Generator	Color bars 100%, Grayscale 11-step, Sawtooth 2H, Checker board, Cross hatch, UV plane
Modes	Six (6) preset programmable modes
Remote Control	Bilinx coaxial bi-directional communication
Video Motion Detection	One area, fully programmable
Controls	OSD with soft-key operation (multi-lingual)

UPH-C610 Series

Camera Model	LTC 0610 Dinion ^{XF} Color, 1/2-inch Digital CCD Camera
Active Pixels	
NTSC	768 H x 492 V
PAL	752 H x 582 V

Sensitivity (3200 k)

Sensitivity (full video) ⁵	1.4 lx (0.14 fc)
Sensitivity 50 IRE ⁵	0.35 lux / 0.14 lux (NightSense) (0.035 fc / 0.014 fc (NightSense))

Minimum Illumination ⁵	0.18 lux / 0.08 lux (NightSense) (0.018 fc / 0.008 fc (NightSense))
Minimum Illumination with SensUp	0.018 lux / 0.008 lux (NightSense) (0.0018 fc / 0.0008 fc (NightSense))
Horizontal Resolution	540 TVL
Signal-to-Noise-Ratio	> 50dB
Video Output	1Vpp, 75 Ohm
Y/C Output	Y: 1 Vpp / C: 0.3 Vpp
Synchronization	Internal, Line Lock, HV-lock and Genlock (Burst lock) selectable
Shutter	Auto (1/60 [1/50] to 1/500000), fixed, flickerless, default
Night Sense	Auto, Forced, Off
SensUp	Off, automatic continuous up to 10x
Auto Black	On/Off selectable
Dynamic Range	32x dynamic range enhancement
Dynamic Noise Reduction	Auto, Off selectable
Contour	Sharpness enhancement level selectable
BLC	Off, area and level selectable
Gain	Auto (maximum level selectable to 28 dB) or fixed level selectable
White Balance	ATW (2500–10000 K), AWB hold, manual WB selectable
VMD	Four (4) area, sensitivity selectable
Alarm Output	VMD or Bilinx
Alarm Input (TTL)	Profile switching, +5 V nominal, +40 VDC max.
Alarm Output Relay	Max. 30 VAC or +40 VDC, max. 0.5 A continuous, 10 VA
External Synchronal Input	75 Ohm or High Impedance selectable
Cable Compensation	Up to 1000 m (3000 ft) coax without external amplifiers (automatic setup in combination with coaxial communication)
Camera ID	16-character editable string, position selectable
Remote Control	Bi-directional coaxial communication

5. F/1.2, 89% reflection, SensUp off

UPH-C630 Series

Camera Model	LTC 0630 Dinion 2X Day/Night, 1/2-inch Digital CCD Camera
Active Pixels	

NTSC	768 H x 494 V
PAL	752 H x 582 V

Sensitivity (3200 K, scene reflectivity 89%, F1.2)

	Full video (100 IRE)	Usable picture (50 IRE)	Usable picture (30 IRE)
Color	1.4 lx (0.14 fc)	0.31 lx (0.031 fc)	0.18 lx (0.018 fc)
Color + SensUp 10x	0.14 lx (0.014 fc)	0.031 lx (0.0031 fc)	0.018 lx (0.0018 fc)
Monochrome	-	0.052 lx (0.0052 fc)	0.024 lx (0.0024 fc)
Monochrome + SensUp 10x	-	0.0052 lx (0.00052 fc)	0.0024 lx (0.00024 fc)

Horizontal Resolution	540 TVL
Signal-to-Noise Ratio	>50 dB
Video Output	Composite video 1 Vpp, 75 ohm
Synchronization	Internal, Line Lock, HV-lock and Genlock (Burst lock) selectable
Shutter	Auto (1/50 [1/60] to 1/10000) selectable Auto (1/50 [1/60] to 1/50000) automatic flickerless, fixed selectable
SensUp	Adjustable from Off up to 10x
Day/Night	Color, Mono, Auto
Auto Black	Automatic continuous, Off
Dynamic Engine	XF-Dynamic, SmartBLC
Dynamic Range	96 dB (16-bit image processing)
Dynamic Noise Reduction	Auto, On/Off selectable
Sharpness	Sharpness enhancement level selectable
SmartBLC	On/Off
AGC	AGC On/OffOff (0 dB) selectable
Peak White Invert	On/Off
White Balance	ATW, ATWhold and manual (2500–10000 K)
Alarm Output	VMD or Bilinx
Alarm Input (TTL)	Profile switching, +3.3 V nominal, +40 VDC max.
Alarm Output Relay	30 VAC or +40 VDC, max. 0.5 A continuous, 10 VA
External Synchronization Input	75 Ohm or High Impedance selectable

Cable Compensation	Up to 1000 m (3000 ft) coax without external amplifiers (automatic set-up in combination with Bilinx coaxial communication)
Camera ID	17-character editable string, position selectable
Test Pattern Generator	Color bars 100%, Greyscale 11-step, Sawtooth 2H, Checker board, Cross hatch, UV plane
Modes	Six (6) preset programmable modes
Remote Control	Bilinx coaxial bi-directional communication
Video Motion Detection	One (1) area, fully programmable
Controls	OSD with soft-key operation (multi-lingual)

Lens Specifications

Model L8585 (LTC 3783/51)	
10x optical	f=8.5 (wide) to 85.0 mm (tele), F1.6
Angle of view (H)	31.3° (wide) to 3.3° (tele)
Model L8120 (LTC 3293/30)	
15x optical	f=8.0 (wide) to 120.0 mm (tele), F1.6
Angle of view (H)	32.5° (wide) to 2.3° (tele)
Model L86154 (LTC 3793/51)	
18x optical	f=8.6 (wide) to 154.0 mm (tele), F2.5
Angle of view (H)	30.5° (wide) to 1.82° (tele)

AEGIS UFLED Illuminator Specifications

LEDs	High-efficiency LED array with current limited integral power circuit
Number of LEDs	18 high-efficiency surface mount LEDs
Beam Patterns	10°, 20°, or 30°
Wavelength	850 nm
Power Draw	26 to 45 W (45 W max. power). Power consumption will vary over time due to the infrared illuminator's optical output control which compensates for LED degradation and ambient temperature fluctuations.
Input Voltage	12 to 40 VDC or 24 VAC ±30%
Temperature Range	-50°C to +50°C (-58°F to +122°F) max. on full power
Environment	IP67
Construction	Robust, aluminum construction with acrylic front fascia
Weight	1.4 kg (3.1 lb)

Dimensions (Single Illuminator)	152 x 188 x 115 mm (6.0 x 7.4 x 4.5 in.)
Color	Black anodized heat sink with black front fascia
Power Cable	Supplied with IP67 power connector and 5 m (16.4 ft) of connecting lead.
Bracket	Wall mount U-bracket supplied

IR Performance Ranges

Model Combination	Beam Pattern	Achievable Distance ⁶
UFLED10-8BD UFLED10-8BD	10° 10°	267 m (876 ft)
UFLED10-8BD UFLED20-8BD	10° 20°	230 m (755 ft)
UFLED10-8BD UFLED30-8BD	10° 30°	218 m (715 ft)
UFLED20-8BD UFLED20-8BD	20° 20°	180 m (590 ft)
UFLED20-8BD UFLED30-8BD	20° 30°	168 m (551 ft)
UFLED30-8BD UFLED30-8BD	30° 30°	132 m (433 ft)

6. Actual illumination distance achieved is dependent on camera and lens characteristics.

Ordering information

UPH-C485N-L8120 Camera/Lens Assembly

LTC 0485 Dinion^{XF} 1/3 in. NTSC color camera with an LTC 3293/30 8-120 mm zoom lens
Order number **UPH-C485N-L8120**

UPH-C485P-L8120 Camera/Lens Assembly

LTC 0485 Dinion^{XF} 1/3 in. PAL color camera with an LTC 3293/30 8-120 mm zoom lens
Order number **UPH-C485P-L8120**

UPH-C498N-L8120 Camera/Lens Assembly

LTC 0498 Dinion 2X 1/3 in. NTSC day/night camera with an LTC 3293/30 8-120 mm zoom lens
Order number **UPH-C498N-L8120**

UPH-C498P-L8120 Camera/Lens Assembly

LTC 0498 Dinion 2X 1/3 in. PAL day/night camera with an LTC 3293/30 8-120 mm zoom lens
Order number **UPH-C498P-L8120**

UPH-C610N-L8120 Camera/Lens Assembly

LTC 0610 Dinion^{XF} 1/2 in. NTSC color camera with an LTC 3293/30 8-120 mm zoom lens
Order number **UPH-C610N-L8120**

UPH-C610P-L8120 Camera/Lens Assembly

LTC 0610 Dinion^{XF} 1/2 in. PAL color camera with an LTC 3293/30 8-120 mm zoom lens
Order number **UPH-C610P-L8120**

UPH-C630N-L8120 Camera/Lens Assembly

LTC 0630 Dinion 2X 1/2 in. NTSC day/night camera with an LTC 3293/30 8-120 mm zoom lens
Order number **UPH-C630N-L8120**

UPH-C630P-L8120 Camera/Lens Assembly

LTC 0630 Dinion 2X 1/2 in. PAL day/night camera with an LTC 3293/30 8-120 mm zoom lens
Order number **UPH-C630P-L8120**

UPH-C498N-L8585 Camera/Lens Assembly

LTC 0498 Dinion 2X 1/3 in. NTSC day/night camera with an LTC 3783/51 8.5-85 mm IR-corrected lens
Order number **UPH-C498N-L8585**

UPH-C498P-L8585 Camera/Lens Assembly

LTC 0498 Dinion 2X 1/3 in. PAL day/night camera with an LTC 3783/51 8.5-85 mm IR-corrected lens
Order number **UPH-C498P-L8585**

UPH-C630N-L8585 Camera/Lens Assembly

LTC 0630 Dinion 2X 1/2 in. NTSC day/night camera with an LTC 3783/51 8.5-85 mm IR-corrected lens
Order number **UPH-C630N-L8585**

UPH-C630P-L8585 Camera/Lens Assembly

LTC 0630 Dinion 2X 1/2 in. PAL day/night camera with an LTC 3783/51 8.5-85 mm IR-corrected lens
Order number **UPH-C630P-L8585**

UPH-C498N-L86154 Camera/Lens Assembly

LTC 0498 Dinion 2X 1/3 in. NTSC day/night camera with an LTC 3793/51 8.6-154 mm IR-corrected zoom lens
Order number **UPH-C498N-L86154**

UPH-C498P-L86154 Camera/Lens Assembly

LTC 0498 Dinion 2X 1/3 in. PAL day/night camera with an LTC 3793/51 8.6-154 mm IR-corrected zoom lens
Order number **UPH-C498P-L86154**

UPH-C630N-L86154 Camera/Lens Assembly

LTC 0630 Dinion 2X 1/2 in. NTSC day/night camera with an LTC 3793/51 8.6-154 mm IR-corrected zoom lens
Order number **UPH-C630N-L86154**

UPH-C630P-L86154 Camera/Lens Assembly

LTC 0630 Dinion 2X 1/2 in. PAL day/night camera with an LTC 3793/51 8.6-154 mm IR-corrected zoom lens
Order number **UPH-C630P-L86154**

UPH-HD-24 Standard High-Speed Positioning System, 24 VAC

High-performance pan/tilt head, camera housing, telemetry receiver, 24 VAC, 50/60 Hz
Order number **UPH-HD-24**

UPH-HD-230 Standard High-Speed Positioning System, 230 VAC

High-performance pan/tilt head, camera housing, telemetry receiver, 230 VAC, 50/60 Hz
Order number **UPH-HD-230**

UPH-HWD-230 Standard High-Speed Positioning System with a wiper, 230 VAC

High-performance pan/tilt head, camera housing, telemetry receiver, and wiper, 230 VAC, 50 Hz
Order number **UPH-HWD-230**

UPH-HWD-120 Standard High-Speed Positioning System with a wiper, 120 VAC

High-performance pan/tilt head, camera housing, telemetry receiver, and wiper, 120 VAC, 60 Hz
Order number **UPH-HWD-120**

UPH-HWD-24 Standard High-Speed Positioning System with a wiper, 24 VAC

High-performance pan/tilt head, camera housing, telemetry receiver, and wiper, 24 VAC, 50/60 Hz
Order number **UPH-HWD-24**

UPH-HWDIR-24 IR 360 High-Speed Positioning System with a wiper, 24 VAC

High-performance pan/tilt head, camera housing, telemetry receiver, and bracket assembly for IR two illuminators, 24 VAC, 50/60 Hz
Order number **UPH-HWDIR-24**

MTC-PUPH Outdoor Pole Mount

for mounting a UPH series unit to the top of a pole
Order number **MTC-PUPH**

MTC-WUPH Outdoor Wall Mount

for UPH series
Order number **MTC-WUPH**

MTC-CORN-W Corner Adapter for MTC-WUPH

Order number **MTC-CORN-W**

MTC-POLE-W Pole Adapter for MTC-WUPH

for mounting a UPH series unit to the side of a pole
Order number **MTC-POLE-W**

Accessories**UFLED10-8BD AEGIS Illuminator**

AEGIS Intelligent-IR UFLED illuminator, 10°, 850 nm
Order number **UFLED10-8BD**

UFLED20-8BD AEGIS Illuminator

AEGIS Intelligent-IR UFLED illuminator, 20°, 850 nm
Order number **UFLED20-8BD**

UFLED30-8BD AEGIS Illuminator

AEGIS Intelligent-IR UFLED illuminator, 30°, 850 nm
Order number **UFLED30-8BD**

HAC-WAS05-20 24 VAC Washer

24 VAC washer inst. 4M 25L
Order number **HAC-WAS05-20**

HAC-WAS05-50 230 VAC Washer

230 VAC washer inst. 4M 25L

Order number **HAC-WAS05-50**

HAC-WAS30-50 230 VAC Washer

230 VAC washer inst. 30M 25L

Order number **HAC-WAS30-50**

WPTV244300UL 4-channel Outdoor Power Supply, 120 VAC

Four-channel, 120 VAC input, 24/28 VAC output,
12.5 A total output, outdoor

Order number **WPTV244300UL**

WPTV244300220 4-channel Outdoor Power Supply, 220 VAC

Four-channel, 220 VAC input, 24/28 VAC output, 12.5
A total output, outdoor

Order number **WPTV244300220**

UFLED-CL-1M Link Cable

1 m (3.3 ft) telemetry link cable for Aegis illuminators

Order number **UFLED-CL-1M**

Represented by:

Americas:

Bosch Security Systems, Inc.
130 Perinton Parkway
Fairport, New York, 14450, USA
Phone: +1 800 289 0096
Fax: +1 585 223 9180
security.sales@us.bosch.com
www.boschsecurity.us

Europe, Middle East, Africa:

Bosch Security Systems B.V.
P.O. Box 80002
5617 BA Eindhoven, The Netherlands
Phone: + 31 40 2577 284
Fax: +31 40 2577 330
emea.securitysystems@bosch.com
www.boschsecurity.com

Asia-Pacific:

Robert Bosch (SEA) Pte Ltd, Security
Systems
11 Bishan Street 21
Singapore 573943
Phone: +65 6571 2808
Fax: +65 6571 2699
apr.securitysystems@bosch.com
www.boschsecurity.asia

China:

Bosch (Shanghai) Security Systems Ltd.
201 Building, No. 333 Fuquan Road
North IBP
Changning District, Shanghai
200335 China
Phone +86 21 22181111
Fax: +86 21 22182398
www.boschsecurity.com.cn

America Latina:

Robert Bosch Ltda Security Systems Division
Via Anhanguera, Km 98
CEP 13065-900
Campinas, Sao Paulo, Brazil
Phone: +55 19 2103 2860
Fax: +55 19 2103 2862
latam.boschsecurity@bosch.com
www.boschsecurity.com